



## Room or building plans

A plan is an overhead view of a room or building. Plans are drawn to scale.

### Example

In this plan of a kitchen/diner the scale is 1 cm to 0.5 m.

Each cm on the plan represents 0.5 m in the actual room.

Measure the length of the room.

It is 12 cm on the plan.

The actual length =  $12 \times 0.5 = 6$  m.

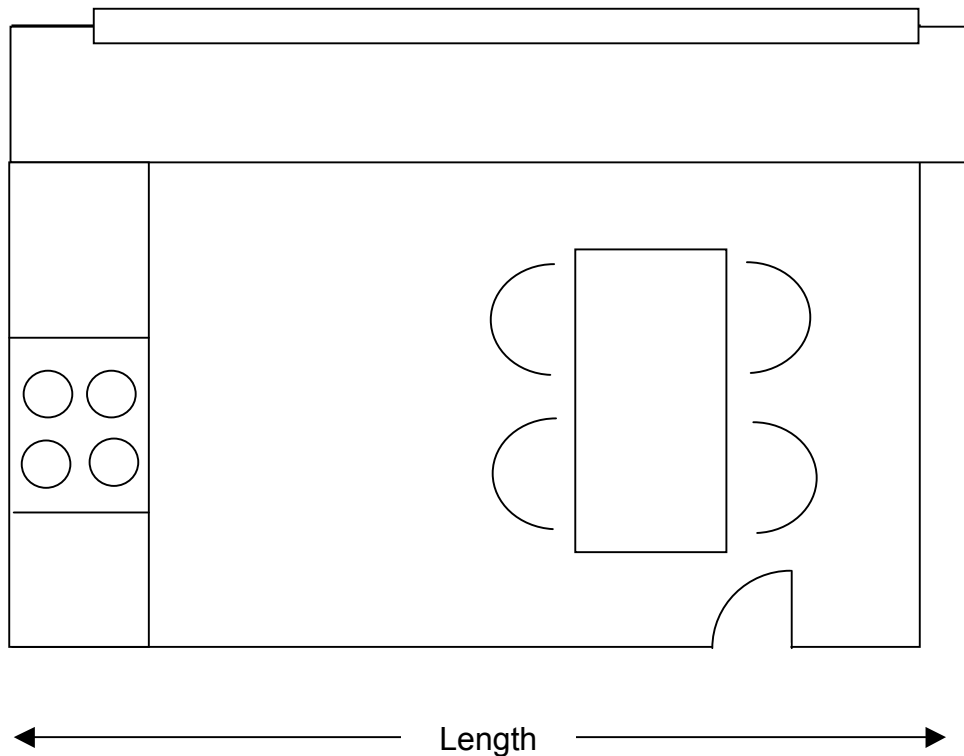

The table's actual measurements are 2 m by 1 m.

On the plan, the measurements are  $2 \div 0.5 = 4$  cm by  $1 \div 0.5 = 2$  cm.